

## WICHTIGER HINWEIS FÜR EINBAU UND MONTAGE

### Montage und Demontage der Drehknöpfe – Aus- Einbau des Gerätes

- Abdeckung (Kappe) mit geeignetem Werkzeug von Drehknopf abheben
- Innenliegende Befestigungsschraube lösen und Drehknopf von Achse abziehen
- 6-Kant-Montage-Schrauben und Kreuzschrauben lösen um Gerät aus- bzw. einzubauen
- Beim Einsetzen der Abdeckung (Kappe) Ausrichtung beachten!

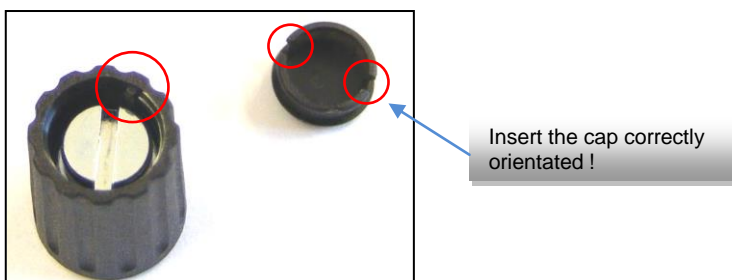
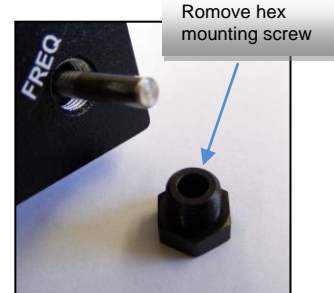
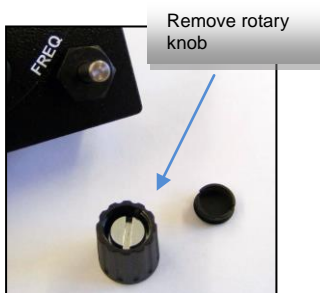
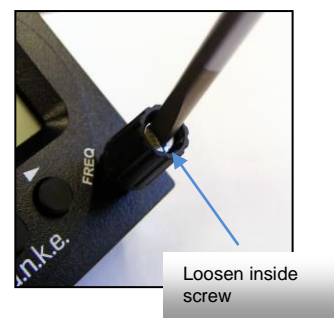
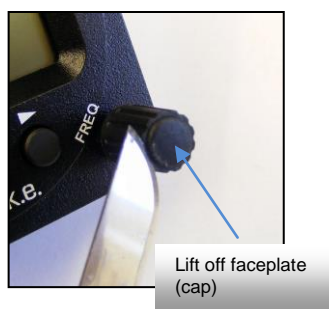
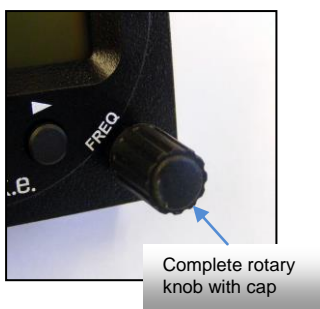
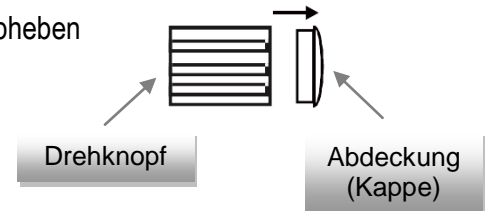

## IMPORTANT NOTES FOR INSTALLATION AND OPERATION

### Mounting and dismantling the Rotary Knobs - Removing or installed device

- Lift off faceplate (cap) from rotary knob with an appropriate tool
- Loosen inside screw and remove rotary knob
- Loosen hex mounting screws and Phillips screws  
Removing or installed device
- Insert faceplate (cap) correctly orientated!

